

Facility: **Saints Church**

Last Updated: **June 9, 2026**
Who: **BS**

Address: **6315 199 St NW**

Contact/Caretaker: **N/A**

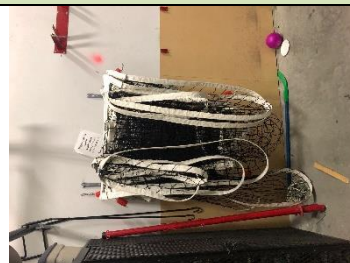
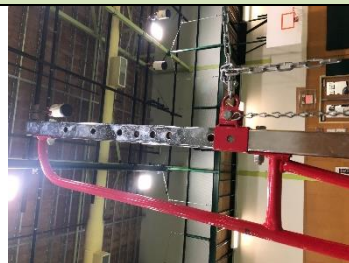

Picture of gym from North

Volleyball posts

Correct hanging of net

Correct net setup

General Information

Parking: Parking is available in the parking lot off 199 street In the Church parking lot

Entrance: Players should enter the Church through the doors labeled Reception

Gym Location: The gym is located on your left when you go through the entrance. You will pass a reception desk and coffee shop.

Changeroom/Washroom: Change rooms are located by the door labeled locker rooms.

Floor: Sport Court, Yellow lines are to be used for volleyball.

Equipment

Sport Specific Equipment Location and details: Equipment storage is located directly across the gymnasium from the entrance

Gym Set-up

Volleyball

Step 1: Take a pair of posts out.

Step 2: Insert the posts into the post holes that are closer to the court lines.

Step 3: Both sides have clips for the net to attach.

Step 4: Use the winch to tighten the top and bottom of the volleyball nets.

Step 5: Repeat this setup for the other court.

Basketball

Court Lines: The basketball hoops can be lowered by the custodian. This gym does have full size glass backboards and a three-point line. Use the black lines for the courts.

Player Benches: For player benches, use any two benches along the side of the gym wall that are outside of the field of play.



www.EdmontonSportsClub.com
17406 106a Ave, Edmonton, AB, T5S 1E6
780.429.GAME(4263)

Set-up Diagram

Diagram:

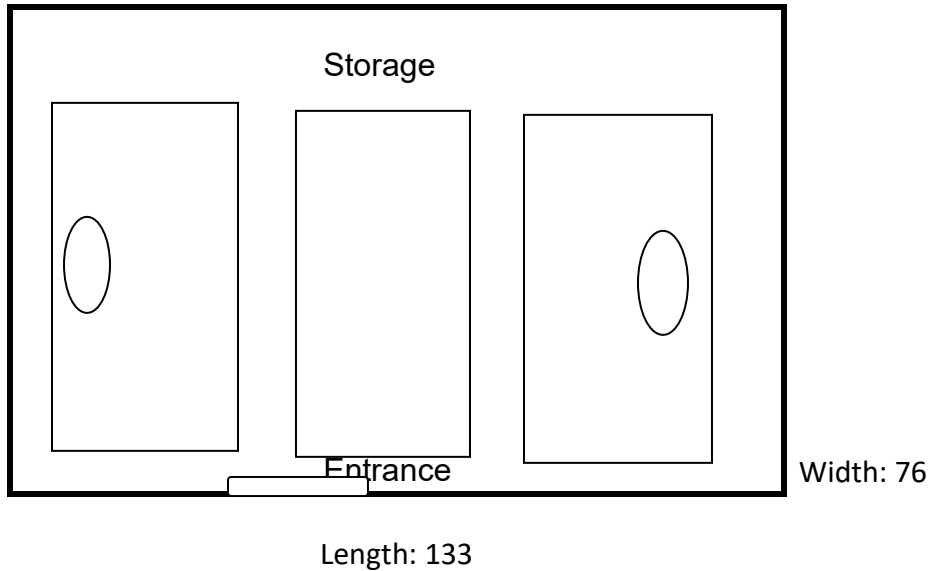

Important Notes

- It is a requirement for Event Coordinators and Games Coordinators to sweep the courts at the end of each booking. Blue dust mops can be found on the walls the equipment storage room to complete this task.