

Facility: **Terwillegar Rec Centre**

Last Updated: **May 22, 2025**
Who: **MM**

Address: **2051 Leger Rd.**
Contact/Caretaker: **City of Edmonton**

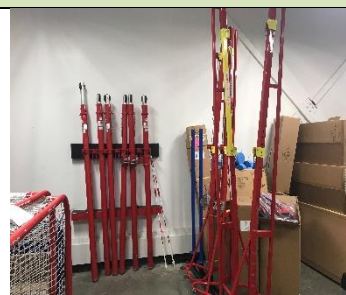

Gym 3

Gym from sideline

Volleyball equipment

Badminton setup

General Information

Parking: Players can park in the main lot on West and Southwest side of the building. This can be accessed off Leger Rd.

Entrance: Players should enter through either entrance #1 or #2 for closest access to the gymnasium

Gym Location: If players enter through entrance #1, the information desk will be located on their left and across from that will be the gym labelled Flexi Hall. If players enter through entrance #2 they will need to turn right before the entrance to the ice rink, proceed down the hallway with the indoor playground and swimming pool and head towards the information desk. On the far side of the information desk they will see the Flexi Hall gym.

Change room/Washroom: Players can change in the washrooms that are located outside the doors to the gym. Please do not change in the hallway.

Floor: The floor should be cleaned by the facility staff. If there are any issues please notify the front desk.

Equipment

Sport Specific Equipment Location and details: The soccer nets and badminton equipment are in the storage room on the East side of gym 2. Please use the soccer goals provided by Terwillegar. The volleyball equipment is stored in room 111.3, in the back right hand corner of the gym 2. The equipment should be set up when you arrive but if you need to adjust the net height, please approach the front desk or gym attendant to have them radio maintenance to bring out the crank and adjust the net height.

Gym Set-up

Volleyball

Step 1: Take one post that cranks the bottom of the nets and one that cranks the top and place them on either side of a court. They should be side by side in the storage room.

Step 2: Insert them into the post holes just off the courts

Step 3: Clip the tops of the nets into the loops on the posts and crank to tighten

Step 4: Clip the bottoms of the nets into the loops and crank to tighten

Step 5: Do not over tighten

Badminton

Step 1: Remove post hole covers and insert the poles into the post holes. 4 posts in total.

Step 2: Thread the string on the top of the net through the hole on the top of the pole, then wrap the string onto the hook on the middle of the pole.



www.EdmontonSportsClub.com
17406 106a Ave, Edmonton, AB, T5S 1E6
780.429.GAME(4263)

Step 3: Thread the string on the bottom of the net through the hole on the center of the pole, then wrap the string around the pole and tie the string onto the hook slightly above this hole.

Step 4: Turn the poles to tighten the nets.

Basketball

This gym has break-away rims and regulation sized glass backboards. There is a 3pt line.

Court Lines: Black basketball court lines easily identifiable in this gym.

Player Benches: Players can sit on the mini-bleachers against any wall, outside of the area of play.

Soccer

Goals: Use the soccer nets that are supplied by Terwillegar. These will be in the storage room.

Set-up Diagram

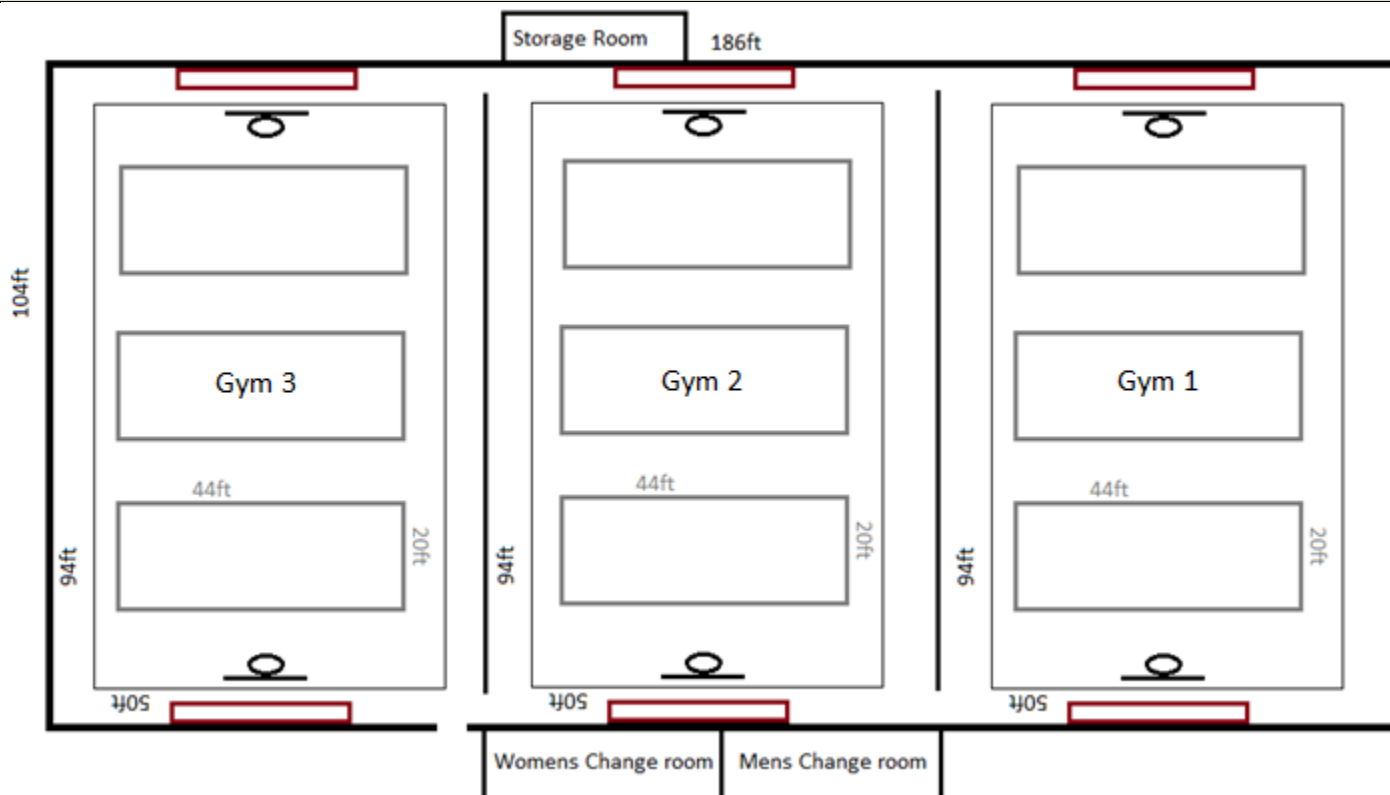

Important Notes

Please make sure to have your permit printed and obey any requests from the Terwillegar staff.